

THIS COPY IS PROVIDED ON A RESTRICTED BASIS AND IS NOT TO BE USED IN ANY WAY DETRIMENTAL TO THE INTERESTS OF PANDUIT CORP.

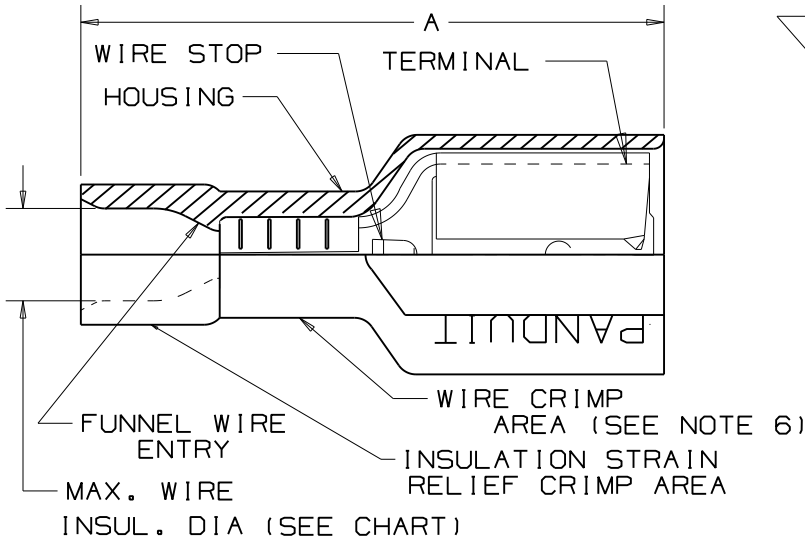

WIRE AND RECEPTACLE SIZES ARE IDENTIFIED ON HOUSING

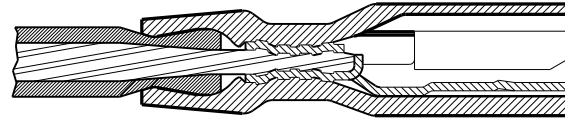
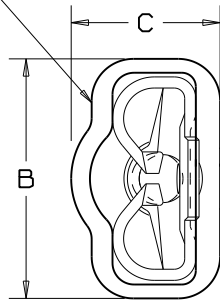

SECTION VIEW OF CRIMPED DISCONNECT

NOTES:

- USED FOR:
  - A: 600V MAX VOLTAGE RATING
  - B: 221°F (105°C) MAX TEMP RATING
  - C: STRANDED COPPER WIRE ONLY
  - D: 6-12 LBS INITIAL INSERTION/WITHDRAWAL FORCE
- PACKAGE QTY: -M=1000 PIECES -D=500 PIECES  
-C=100 PIECES -L=50 PIECES
- MATERIAL:
  - A. STAMPING-CDA 260 BRASS, TIN PLATED
  - B. HOUSING-PREMIUM GRADE NYLON FOR SUPERIOR STRAIN RELIEF INSULATION CRIMPING
- DIMENSIONS IN BRACKETS ARE IN mm OR mm<sup>2</sup>
- NYLON HOUSING IS OPAQUE
- THE DPF10-250F1 IS CONSTRUCTED WITH AN ADDITIONAL BRASS SLEEVE IN THE CRIMP AREA

PART NUMBER	PKG. SUFFIX	TAB SIZE	WIRE RANGE AWG (mm) <sup>2</sup>	COLOR (note 5)	MAX. WIRE INSULATION DIAMETER	MIN. WIRE INSULATION DIAMETER	DIMENSIONS in.			WIRE STRIP LENGTH	TOOL CHART
							A ±.03 (.8)	B ±.01 (.3)	C ±.01 (.3)		
DPF18-250F1BR	-C	.250 X .032 (6,3 X 0,8)	22-18 (0,5-1,0)	RED	.106 (2,69)	.060 (1,52)	.84 (21,3)	.35 (8,9)	.22 (5,6)	9/32 <sup>+1/32</sup> -0 (7.1 <sup>+0.8</sup> -0)	CT-1525
DPF18-205F1BR	-C	.205/.187 X .032 (5,2/4,8 X .8)	22-18 (0,5-1,0)	RED	.106 (2,69)	.060 (1,52)	.78 (19,8)	.31 (7,9)	.22 (5,6)		
DPF18-206F1BR	-C	.205/.187 X .020 (5,2/4,8 X .5)	22-18 (0,5-1,0)	RED	.106 (2,69)	.060 (1,52)	.78 (19,8)	.31 (7,9)	.22 (5,6)		
DPF18-250F1B	-M	.250 X .032 (6,3 X 0,8)	22-18 (0,5-1,0)	RED	.133 (3,38)	.080 (2,03)	.84 (21,3)	.35 (8,9)	.22 (5,6)		
DPF18-205F1B	-M	.205/.187 X .032 (5,2/4,8 X .8)	22-18 (0,5-1,0)	RED	.133 (3,38)	.080 (2,03)	.78 (19,8)	.31 (7,9)	.22 (5,6)		
DPF18-206F1B	-M	.205/.187 X .020 (5,2/4,8 X .5)	22-18 (0,5-1,0)	RED	.133 (3,38)	.080 (2,03)	.78 (19,8)	.31 (7,9)	.22 (5,6)		
DPF14-250F1B	-M	.250 X .032 (6,3 X 0,8)	16-14 (1,5-2,5)	BLUE	.156 (3,96)	.090 (2,29)	.84 (21,3)	.35 (8,9)	.22 (5,6)		
DPF14-205F1B	-M	.205/.187 X .032 (5,2/4,8 X .8)	16-14 (1,5-2,5)	BLUE	.156 (3,96)	.090 (2,29)	.78 (19,8)	.31 (7,9)	.22 (5,6)		
DPF14-206F1B	-M	.205/.187 X .020 (5,2/4,8 X .8)	16-14 (1,5-2,5)	BLUE	.156 (3,96)	.090 (2,29)	.78 (19,8)	.31 (7,9)	.22 (5,6)		
DPF10-250F1B	-D	.250 X .032 (6,3 X 0,8)	12-10 (4,0-6,0)	YELLOW	.220 (5,59)	.140 (3,56)	.96 (24,4)	.35 (8,9)	.23 (5,8)		
DPF10-250F1*	-D	.250 X .032 (6,3 X 0,8)	12-10 (4,0-6,0)	YELLOW	.218 (5,54)	.140 (3,56)	.95 (24,1)	.36 (9,1)	.27 (6,9)	3/8 <sup>+1/32</sup> -0 (9,5 <sup>+0.8</sup> -0)	CT-1550 CT-1551 CT-550

UL LISTED 20H3 E78522

SA CERTIFIED LR31212

\*DPF10-250F1 IS NOT UL LISTED OR CSA CERTIFIED

Panduit part numbers shown on this drawing meet the material requirements of RoHS (EUROPEAN DIRECTIVES 2002/95/EC) as proposed by the Technical Adaptation Committee.

A41462\_09

**PANDUIT**

CORP.

TINLEY PARK, ILLINOIS

DISCOGRIP™ LOOSE PIECE  
FULLY INSULATED FEMALE DISCONNECTS  
.250 X .032, .205 X .032/.020

09 02/08 SRB

Added New Part numbers DPF18-205F1BR-C, DPF18-206F1BR-C, DPF18-250F1BR-C.

REV DATE BY CHK

DESCRIPTION

ECN # CUST PM

DRAWN BY KRC

CHK'D LA

SCALE NONE

DRAWING NO./CAD FILENAME 41462A